

Copying

For details, refer to the *User Guide*.

1



X: 85–432 mm (3.3–17 in.)
Y: 125–297 mm (4.9–11.7 in.)



38–128 g/m²
(26 lb. Text–34 lb. Bond)



≤130 (80 g/m², 20 lb. Bond)
B8270: ≤250

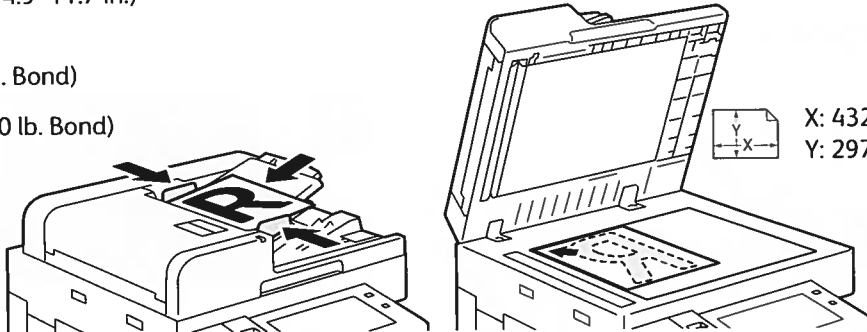
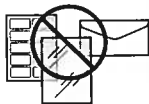

X: 432 mm (17 in.)
Y: 297 mm (11.7 in.)

Load the original documents.

2



Touch **Copy**, then and select the number of copies.

3

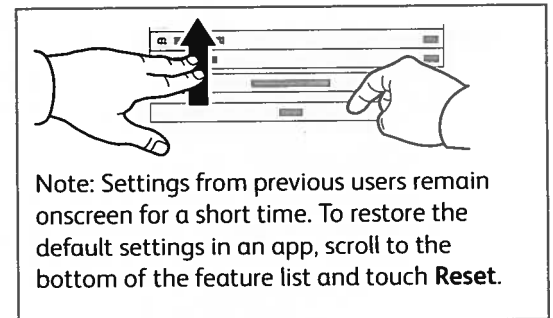
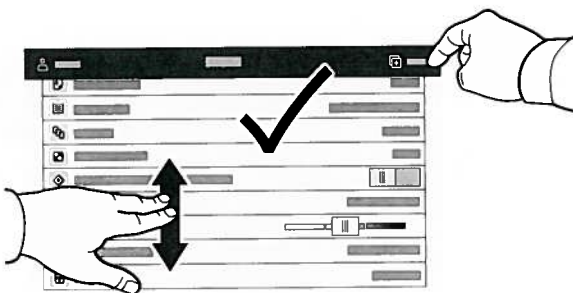

Note: Settings from previous users remain onscreen for a short time. To restore the default settings in an app, scroll to the bottom of the feature list and touch **Reset**.

Select feature settings from the list, then touch **Start**.